



Submittal Data Information

VM06 Series Pumps

301-2003B

Single and Three Phase, 60 Cycle, 3450 RPM

SUPERSEDES: August 5, 2013

EFFECTIVE: December 16, 2013

JOB _____

MODEL _____

ENGINEER _____

CONTRACTOR _____

REP. _____

ITEM NO.	MODEL NO.	IMPELLER DIA.	G.P.M.	HEAD/FT.	H.P.	ELEC. CHARS.

DIMENSIONS AND SPECIFICATIONS

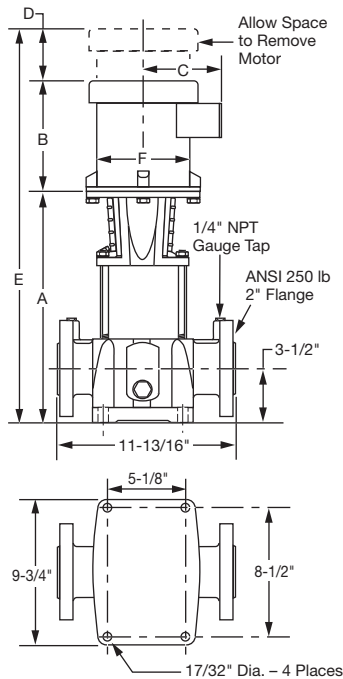
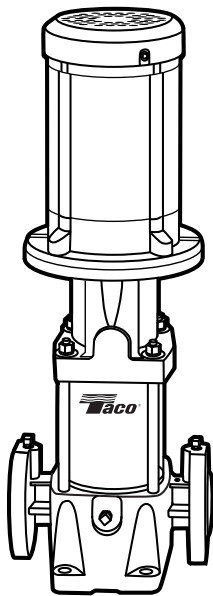

MATERIALS OF CONSTRUCTION

COMPONENT	STANDARD	OPTIONAL
Casing	Class 30 Cast Iron	AISI 304 SS / AISI 316 SS
Impellers	AISI 304 SS	AISI 304 SS / AISI 316 SS
Diffusers	AISI 304 SS	AISI 304 SS / AISI 316 SS
Shaft	AISI 431 SS	Same
Elastomers	EDPM	Consult Factory
Intermediate Bearings	Aluminum Oxide Ceramic	Same
Bearing Ring	Tungsten Carbide	Same
Mechanical Seal	Tungsten Carbide/Carbon EPDM	Consult Factory

OPERATING SPECIFICATIONS

Max. Working Temp.	5°F (-15°C) to 250°F (120°C)
Max. Working Pressure	360 psi (25 Bar)
Min. Rate of Flow	8.5 GPM
Pipe Connections	2" CLASS 300

* Measurements represent the largest number possible for each Model

Model Number	HP	Motor S.F.	Ph	Volts	Frame Size	Disc. Size	Suc. Size	Dimension in Inches*						TEFC Wt.	ODP Wt.
								A	B	C	D	E	F		
VM0602	5	1.15	1	208-230	213TC	2	2	19 ⁵ / ₈	15 ¹ / ₄	8	3 ³ / ₈	38 ¹ / ₄	10 ⁵ / ₈	239	204
VM0602	5	1.15	3	208-230/460	184TC	2	2	19 ⁵ / ₈	13 ⁵ / ₈	6 ⁷ / ₈	2 ⁷ / ₈	36 ¹ / ₈	8 ¹ / ₂	187	171
VM0603	7.5	1.15	1	208-230	213TC	2	2	19 ⁵ / ₈	15 ¹ / ₄	8	3 ³ / ₈	38 ¹ / ₄	10 ⁵ / ₈	226	217
VM0603	7.5	1.15	3	208-230/460	213TC	2	2	19 ⁵ / ₈	15 ¹ / ₄	7 ¹ / ₂	3 ³ / ₈	38 ¹ / ₄	10 ³ / ₈	202	189
VM0604	7.5	1.15	1	208-230	213TC	2	2	21 ¹ / ₈	15 ¹ / ₄	8	3 ³ / ₈	40	10 ⁵ / ₈	254	220
VM0604	7.5	1.15	3	208-230/460	213TC	2	2	21 ¹ / ₈	15 ¹ / ₄	7 ⁷ / ₈	3 ³ / ₈	40	10 ³ / ₈	206	192
VM0605	10	1.15	1	208-230	215TC	2	2	23 ¹ / ₈	16 ³ / ₈	8 ³ / ₄	3 ³ / ₈	42 ⁷ / ₈	10 ⁵ / ₈	427	221
VM0605	10	1.15	3	208-230/460	215TC	2	2	23 ¹ / ₈	15 ¹ / ₄	8	3 ³ / ₈	41 ³ / ₄	10 ³ / ₈	251	209
VM0606	15	1.15	3	208-230/460	254TC	2	2	25 ⁵ / ₈	19 ⁵ / ₈	9 ¹ / ₂	4 ¹ / ₄	49 ¹ / ₄	13	343	247
VM0607	15	1.15	3	208-230/460	254TC	2	2	27 ¹ / ₈	19 ⁵ / ₈	9 ¹ / ₂	4 ¹ / ₄	51	13	336	224
VM0608	15	1.15	3	208-230/460	254TC	2	2	28 ⁷ / ₈	19 ⁵ / ₈	9 ¹ / ₂	4 ¹ / ₄	52 ⁷ / ₈	13	337	231
VM0610	20	1.15	3	230/460	254TC	2	2	32	21 ³ / ₄	9 ¹ / ₂	4	57 ³ / ₄	11 ¹ / ₂	418	347
VM0612	25	1.15	3	230/460	284TSC	2	2	35 ³ / ₈	21 ³ / ₄	9 ¹ / ₂	3 ¹ / ₄	60 ³ / ₈	13	471	559

VM06 – Series Performance Curves

Nominal RPM: 3450
 Based on Fresh Water @ 68°F
 Maximum Working Pressure: 360 PSI

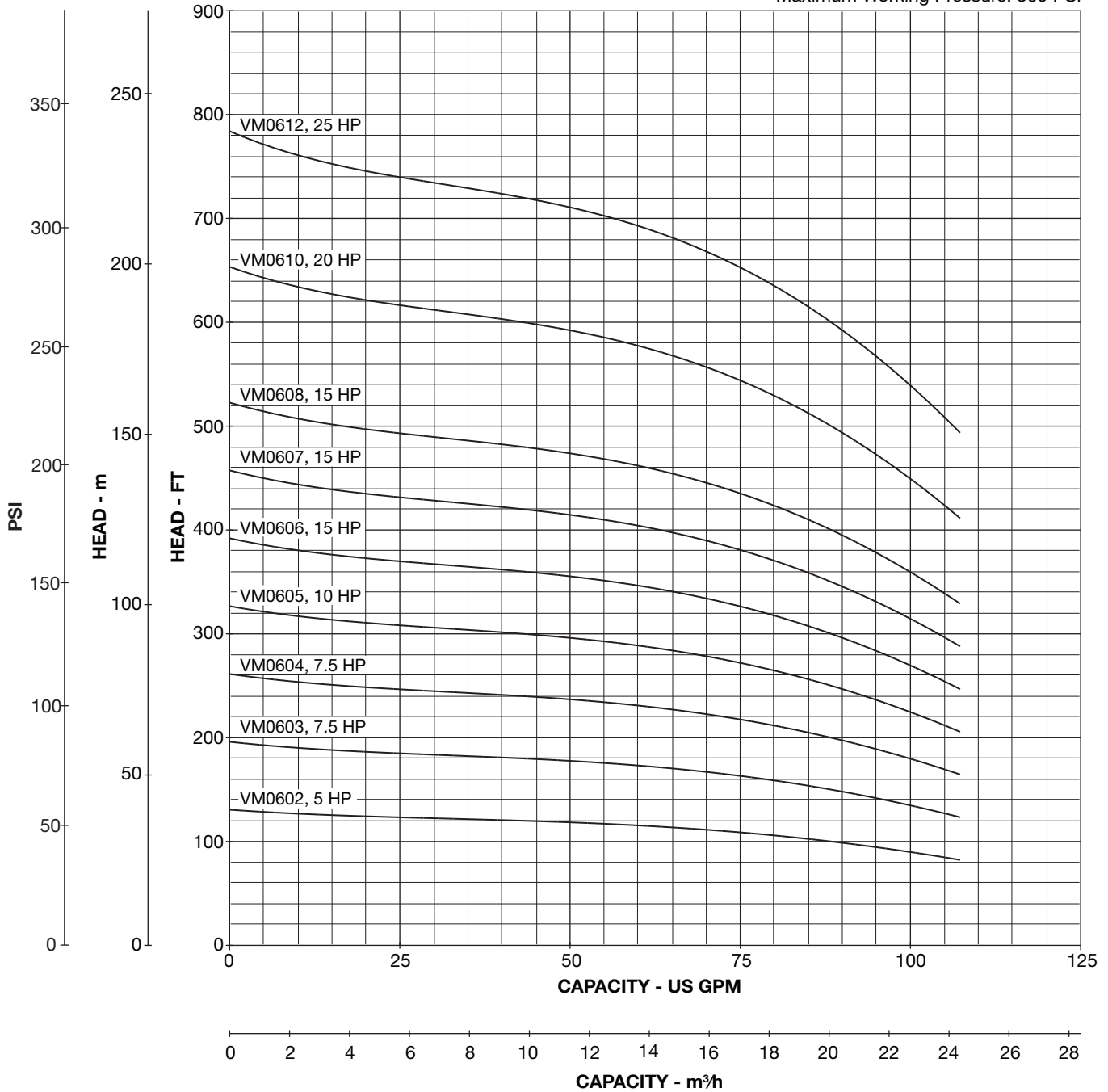

VM06 Series – Single Stage Performance Data

Nominal RPM: 3450
 Based on Fresh Water @ 68°F
 Maximum Working Pressure: 360 PSI

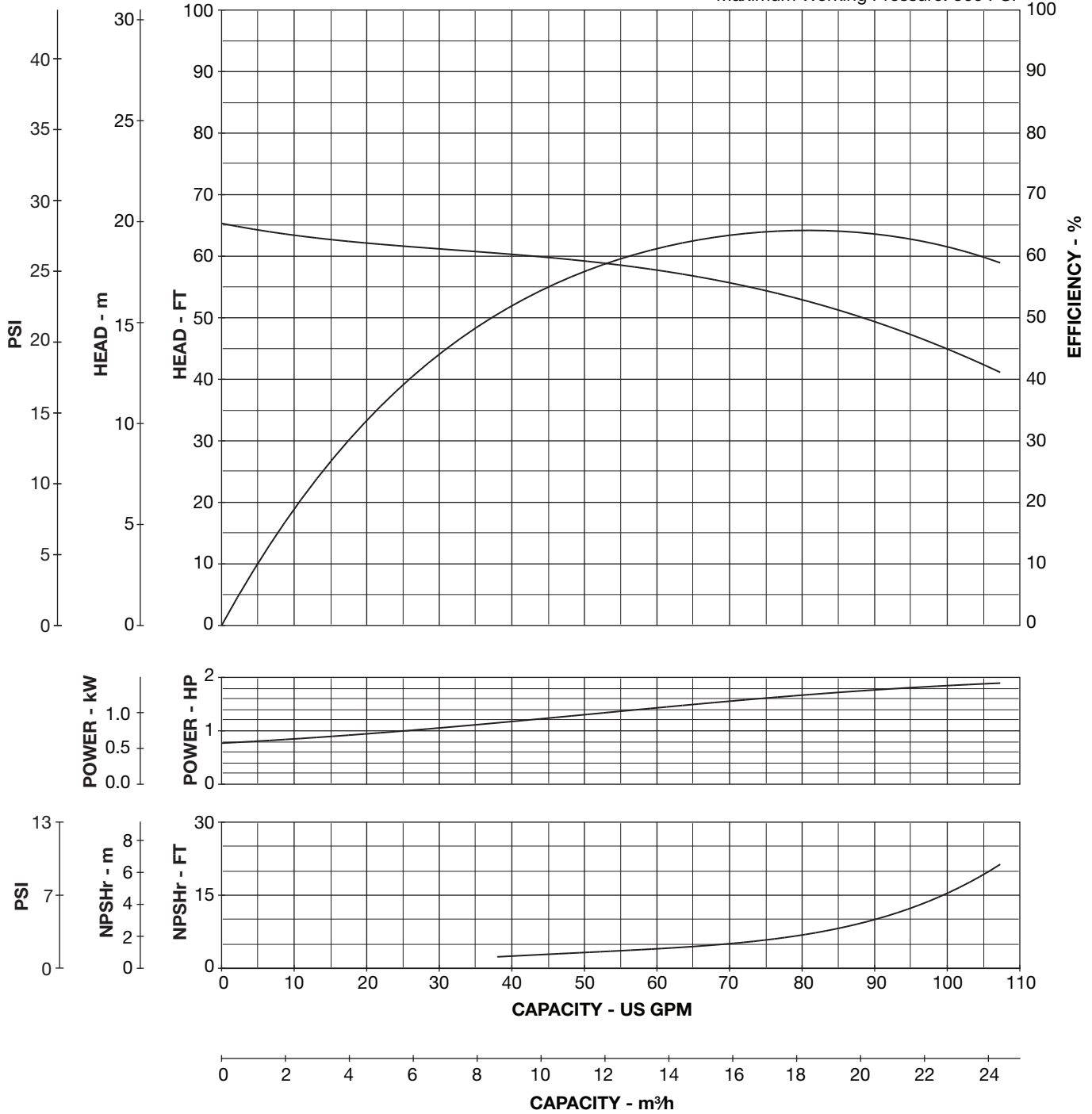

Permissible Operating Pressure Curves

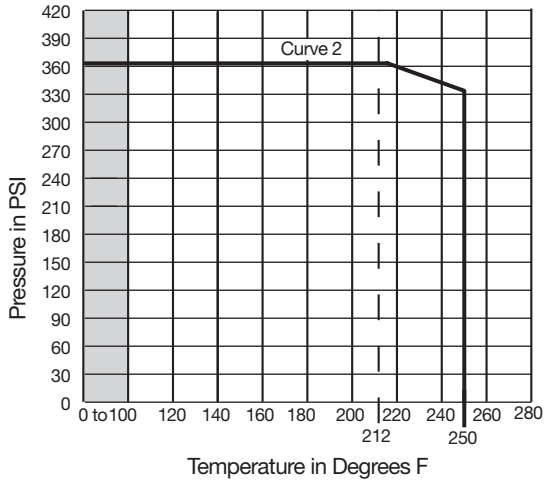

Suggested Specifications:

Furnish and install vertical multistage radial split case pump(s) with the capacities and characteristics as shown on the plans. Pumps shall be TACO Model VM or approved equal.

All wetted surfaces of the pump shall be stainless steel or cast iron. The pump shall be fitted with replaceable TEFLON wear rings to insure alignment and to prevent impeller recirculation. The impeller shall be balanced by design and not require balancing in the field. The impeller(s) shall be 304 stainless steel.

The mechanical seal shall be a single unbalanced type that has a Carbon Graphite stationary seat and a Tungsten Carbide rotating face. The seal housing shall be manually vented upon startup so that air is not trapped in the area directly around the seal.

The pump shaft shall be a double flat stainless steel shaft. The shaft intermediate bearings and bearing ring shall be aluminum oxide ceramic and tungsten carbide, respectively, and be water lubricated.

TACO Comfort Solutions™ A Taco Group Company

Taco, Inc., 1160 Cranston Street, Cranston, RI 02920 | Tel: (401) 942-8000 | FAX: (401) 942-2360

Taco (Canada), Ltd., 8450 Lawson Road, Suite #3, Milton, Ontario L9T 0J8 | Tel: (905) 564-9422 | FAX: (905) 564-9436

Visit our web site: www.TacoComfort.com | Printed in USA | ©2015 Taco, Inc.

